

SUP-⁺STUD[®] V

AVAILABLE MATERIALS

- Carbon steel, zinc plated
- Carbon steel clip, zinc plated

FEATURES/ADVANTAGES

- Required hole diameter equals anchor diameter
- Excellent for setting immediately
- Can be loaded immediately
- Can be set in a bottomless hole
- Nut and washer supplied in package

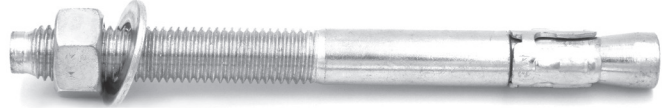

CONCERNS

- Do not use in brick or block
- Not advised for use where vibratory loads are high
- Oversize holes are detrimental and will reduce load performance

ORDER DETAIL

Order Code	Anchor Diameter & Length	Thread Length	Hole Diameter	Length ID	Max Thk Mat to be anchored	Required Torque to set (ft. lbs.)	Box Qty.	Master Qty.
2414135	1/4" x 1-3/4"	1"	1/4"	A	3/8"	10	100	800
2414214	1/4" x 2-3/4"	1-3/8"	1/4"	B	7/8"	10	100	800
2414314	1/4" x 3-3/4"	2-1/4"	1/4"	D	1-7/8"	10	100	800
2438214	3/8" x 2-1/4"	1"	3/8"	B	1/4"	30	50	400
2438234	3/8" x 2-3/4"	1-1/2"	3/8"	C	3/4"	30	50	400
2438300	3/8" x 3"	1-3/4"	3/8"	D	1/4"	30	50	400
2438334	3/8" x 3-3/4"	2-1/2"	3/8"	E	1"	30	50	400
2438500	3/8" x 5"	3-3/4"	3/8"	H	2-1/4"	30	50	250
2412234	1/2" x 2-3/4"	1-1/8"	1/2"	C	1/8"	80	50	150
2412334	1/2" x 2-3/4"	2-1/8"	1/2"	E	3/4"	80	50	150
2412414	1/2" x 4-1/4"	2-3/8"	1/2"	F	1-1/4"	80	50	150
2412512	1/2" x 5-1/2"	3-3/4"	1/2"	I	2-1/2"	80	50	150
2412700	1/2" x 7"	4"	1/2"	L	4"	80	25	75
2412812	1/2" x 8-1/2"	4"	1/2"	O	5-1/2"	80	25	75
2458312	5/8" x 3-1/2"	1-3/4"	5/8"	E	1/8"	100	25	75
2458412	5/8" x 4-1/2"	2-1/2"	5/8"	G	1/2"	100	25	75
2458500	5/8" x 5"	3-1/4"	5/8"	H	1"	100	25	75
2458600	5/8" x 6"	4"	5/8"	J	2"	100	25	75
2458700	5/8" x 7"	4"	5/8"	L	3"	100	20	60
2458812	5/8" x 8-1/2"	4"	5/8"	O	4-1/2"	100	20	60
2458100	5/8" x 10"	4"	5/8"	R	6"	100	20	60
2434414	3/4" x 4-1/4"	2-1/8"	3/4"	F	1/8"	120	25	75
2434434	3/4" x 4-3/4"	2-5/8"	3/4"	G	5/8"	120	25	75
2434512	3/4" x 5-1/2"	3-1/4"	3/4"	I	3/4"	120	20	60
2434614	3/4" x 6-1/4"	3-1/4"	3/4"	J	1-1/2"	120	20	60
2434700	3/4" x 7"	4"	3/4"	L	2-1/4"	120	15	45
2434812	3/4" x 8-1/2"	4"	3/4"	O	3-3/4"	120	15	45
2434100	3/4" x 10"	4"	3/4"	R	5-1/4"	120	15	45

INSTALLATION

- 1 Select the correct diameter drill bit, drill a hole to minimum required hole depth or deeper.
- 2 Remove drilling debris from the bottom of the drill hole using a blowout bulb, compressed air or vacuum.

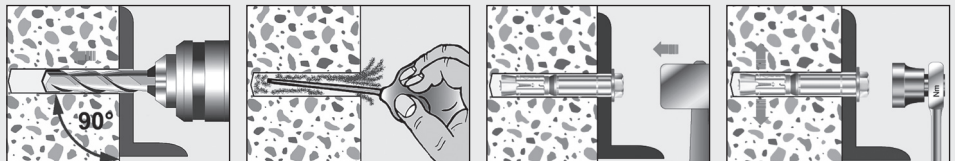

- 3 Assemble the nut & washer past the impact end of the SRS+. Use a hammer to tap the anchor through the part being fastened into the drilled hole until the washer is in contact with the part.
- 4 Using a torque wrench, apply the specified installation torque.