

Sup-R-Stud®

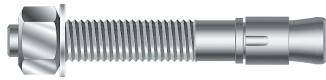

Sup-R-Stud®

Available Materials

- Carbon steel, zinc plated
- Carbon steel, mechanically galvanized
- Grade 5, yellow di-chromated
- 303/304 stainless steel
- 316 stainless steel

Features/Advantages

- Required hole diameter equals anchor diameter
- Excellent for setting immediately
- Can be loaded immediately
- Can be set in a bottomless hole
- Simple installation
- Nut and washer supplied in package
- ROHS compliant except for Grade 5

Concerns

- Do not use in brick or block
- Not advised for use where vibratory loads are high
- Oversize holes are detrimental and will reduce load performance

Approvals/Listings

- G.S.A. Spec FF-S-325C, Group II, Type 4, Class 1
- UL listed 3/8" - 1" (except 7/8")
- FM 3/8", 1/2", 3/4"
- Contact customer service for approvals / listings for state D.O.T.'s

Installation

- 1 Drill hole 1/2" to 1" deeper than anchor embedment.
- 2 Clean hole of debris.
- 3 With nut threaded past the end of stud, hammer into position.
- 4 Tighten finger tight plus an additional 3-5 turns with wrench.
- 5 If anchor spins in hole, force anchor up using screwdriver until clip binds into concrete.

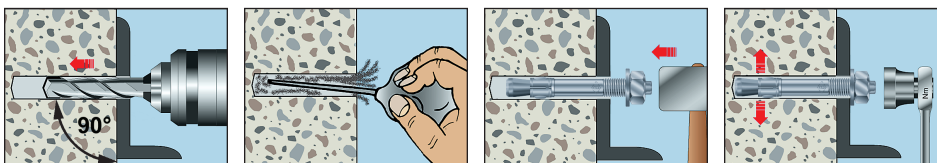

NOTE: The load values below are for all lengths of a given diameter capable of reaching the specified embedment.

Ultimate Tensile & Shear Loads in Lbs.				
Diameter- Threads	Embedment	2000 P.S.I.		Shear
		Tension	Tension	
1/4" - 20	1 1/8"	1,173	1,015	1,472
	2 1/4"	2,573	2,711	
3/8" - 16	1 5/8"	2,289	2,367	3,151
	3 3/8"	3,556	5,203	
1/2" - 13	2 1/4"	4,120	5,068	6,828
	4 1/2"	4,608	5,772	
5/8" - 11	2 3/4"	5,486	5,556	9,659
	5 5/8"	6,957	9,294	
3/4" - 10	3 3/8"	9,267	11,975	15,126
	6 3/4"	13,278	16,201	
7/8" - 9	4"	9,746	13,902	21,574
	8"	14,378	20,288	
1" - 8	4 1/2"	10,226	15,829	28,023
	9"	15,479	24,375	
1 1/4" - 7	6 1/2"	14,720	23,090	33,000

Anchor Spacing / Edge Distance

Anchor Diameter	Min. Anchor Spacing *	Min. Edge Distance *
1/4"	2 1/2"	1 1/4"
3/8"	3 3/4"	1 7/8"
1/2"	5"	2 1/2"
5/8"	6 1/4"	3 1/8"
3/4"	7 1/2"	3 3/8"
7/8"	8 3/4"	4 3/8"
1"	10"	5"
1 1/4"	12 1/2"	6 1/4"

* To obtain 100% load as published

Order Detail

*Sizes made to order.

Carbon Steel		Galvanized			303/304 Stainless		316 Stainless		Grade 5 Steel			Hole Dia.	Length ID	Max Thk Mat to be Anchored	Required Torque to Set (ft. lbs.)	Box Qty.	Master Qty.
Anchor Dia. & Length	Order Code	Thread Length	Order Code	Thread Length	Order Code	Thread Length	Order Code	Thread Length	Order Code	Thread Length							
1/4 x 1 1/2	2614TIE	—	—	—	—	—	—	—	—	—	1/4"	—	—	—	100	800	
1/4 x 1 3/4	2614134	7/8"	2814134	7/8"	2714134	7/8"	2714135	7/8"	2514134	7/8"	1/4"	A	3/8"	8-10	100	800	
1/4 x 2 1/4	2614214	1 3/8"	2814214	1 3/8"	2714214	1 3/8"	2714215	1 3/8"	2514214	1 3/8"	1/4"	B	7/8"	8-10	100	800	
1/4 x 3 1/4	2614314	2 1/4"	2814314	2 1/4"	2714314	2 1/4"	2714315*	2 1/4"	2514314	2 1/4"	1/4"	D	1 7/8"	8-10	100	800	
3/8 x 2 1/4	2638214	1 3/16"	2838214	1 3/16"	2738214	1 3/16"	2738215*	1 3/16"	2538214	1 3/16"	3/8"	B	1/4"	15-30	50	400	
3/8 x 2 3/4	2638234	1 5/8"	2838234	1 5/8"	2738234	1 5/8"	2738235*	1 5/8"	2538234*	1 5/8"	3/8"	C	3/4"	15-30	50	400	
3/8 x 3	2638300	1 7/8"	2838300	1 7/8"	2738300	1 7/8"	2738305	1 7/8"	2538300	1 7/8"	3/8"	D	1"	15-30	50	400	
3/8 x 3 3/4	2638334	2 5/8"	2838334	2 5/8"	2738334	2 5/8"	2738335	2 5/8"	2538334	2 5/8"	3/8"	E	1 3/4"	15-30	50	400	
3/8 x 5	2638500	4"	2838500	4"	2738500	4"	2738505*	4"	2538500	4"	3/8"	H	3"	15-30	50	250	
1/2 x 2 3/4	2612234	1 1/2"	2812234	1 1/2"	2712234	1 1/2"	2712235	1 1/2"	2512234	1 1/2"	1/2"	C	1/8"	25-50	50	150	
1/2 x 3 3/4	2612334	2 1/2"	2812334	2 1/2"	2712334	2 1/2"	2712335*	2 1/2"	2512334*	2 1/2"	1/2"	E	1"	25-50	50	150	
1/2 x 4 1/4	2612414	3"	2812414	3"	2712414	3"	2712415	3"	2512414	3"	1/2"	F	1 1/2"	25-50	50	150	
1/2 x 5 1/2	2612512	4"	2812512	4"	2712512	4"	2712515*	4"	2512512	4"	1/2"	I	2 3/4"	25-50	50	150	
1/2 x 7	2612700	4"	2812700	4"	2712700	1 1/4"	2712705*	1 1/4"	2512700	1 1/4"	1/2"	L	4 1/4"	25-50	25	75	
1/2 x 8 1/2	2612812	4"	2812812	4"	2712812*	1 1/4"	2712815*	1 1/4"	2512812	1 1/4"	1/2"	O	5 3/4"	25-50	25	75	
5/8 x 3 1/2	2658312	1 5/8"	2858312	1 5/8"	2758312	1 5/8"	2758315*	1 5/8"	2558312	1 5/8"	5/8"	E	1/8"	40-75	25	75	
5/8 x 4 1/2	2658412	2 5/8"	2858412	2 5/8"	2758412*	2 5/8"	2758415*	2 5/8"	2558412	2 5/8"	5/8"	G	1 1/8"	40-75	25	75	
5/8 x 5	2658500	3 1/4"	2858500	3 1/4"	2758500	3 1/4"	2758505	3 1/4"	2558500	3 1/4"	5/8"	H	1 5/8"	40-75	25	75	
5/8 x 6	2658600	4 1/8"	2858600	4 1/8"	2758600	4 1/8"	2758605*	4 1/8"	2558600	4 1/8"	5/8"	J	2 5/8"	40-75	25	75	
5/8 x 7	2658700	4"	2858700	4"	2758700*	1 1/2"	2758705*	1 1/2"	2558700	1 1/2"	5/8"	L	3 5/8"	40-75	25	75	
5/8 x 8 1/2	2658812	4"	2858812	4"	2758812*	1 1/2"	2758815*	1 1/2"	2558812	1 1/2"	5/8"	O	5 1/8"	40-75	25	75	
5/8 x 10	2658100	4"	2858100	4"	2758100*	1 1/2"	2758105*	1 1/2"	2558100*	1 1/2"	5/8"	R	6 5/8"	40-75	25	50	
3/4 x 4 1/4	2634414	2 3/8"	2834414	2 3/8"	2734414	2 3/8"	2734415*	2 3/8"	2534414	2 3/8"	3/4"	F	1/8"	100-200	25	75	
3/4 x 4 3/4	2634434	2 7/8"	2834434	2 7/8"	2734434	2 7/8"	2734435	2 7/8"	2534434	2 7/8"	3/4"	G	5/8"	100-200	25	75	
3/4 x 5 1/2	2634512	3 5/8"	2834512	3 5/8"	2734512	3 5/8"	2734515	3 5/8"	2534512	3 5/8"	3/4"	I	1 3/8"	100-200	20	60	
3/4 x 6 1/4	2634614	4 1/4"	2834614	4 1/4"	2734614*	4 1/4"	2734615*	4 1/4"	2534614	4 1/4"	3/4"	J	2 1/8"	100-200	20	60	
3/4 x 7	2634700	4"	2834700	4"	2734700	2"	2734705*	2"	2534700	2"	3/4"	L	2 7/8"	100-200	15	45	
3/4 x 8 1/2	2634812	4"	2834812	4"	2734812	2"	2734815*	2"	2534812	2"	3/4"	O	4 3/8"	100-200	15	45	
3/4 x 10	2634100	4"	2834100	4"	2734100	2"	2734105*	2"	2534100	2"	3/4"	R	5 7/8"	100-200	15	30	
3/4 x 12	263412T	4"	283412T	4"	2734120*	2"	2734125*	2"	2534120*	2"	3/4"	T	7 7/8"	100-200	15	30	
7/8 x 6	2678600	3 1/2"	2878600	3 1/2"	2778600*	2 1/4"	2778605*	2 1/4"	2578600	2 1/4"	7/8"	J	1 1/8"	125-225	10	30	
7/8 x 8	2678800	4"	2878800	4"	2778800*	2 1/4"	2778805*	2 1/4"	2578800	2 1/4"	7/8"	N	3 1/8"	125-225	10	30	
7/8 x 10	2678100	4"	2878100	4"	2778100*	2 1/4"	2778105*	2 1/4"	2578100	2 1/4"	7/8"	R	5 1/8"	125-225	10	20	
1 x 6	2616000	3 1/2"	2816000	3 1/2"	2716000	2 1/4"	2716005*	2 1/4"	2516000	2 1/4"	1"	J	1/2"	150-250	10	30	
1 x 9	2619000	4"	2819000	4"	2719000	2 1/4"	2719005*	2 1/4"	2519000	2 1/4"	1"	P	3 1/2"	150-250	10	20	
1 x 12	2611200	4"	2811200	4"	2711200	2 1/4"	2711205*	2 1/4"	2511200*	2 1/4"	1"	T	6 1/2"	150-250	10	20	
1 1/4 x 9	2611490	3 1/4"	2811490	3 1/4"	2711490*	3 1/4"	2711495*	3 1/4"	2511490	3 1/4"	1 1/4"	P	1 1/4"	200-350	5	15	
1 1/4 x 12	2611412	3 1/4"	2811412	3 1/4"	2711412*	3 1/4"	2711415*	3 1/4"	2511412	3 1/4"	1 1/4"	T	4 1/4"	200-350	5	10	

Installation

- 1 Drill hole 1/2" to 1" deeper than anchor embedment.
- 2 Clean hole of debris.
- 3 With nut threaded past the end of stud, hammer into position.
- 4 Tighten finger tight plus an additional 3-5 turns with wrench.
- 5 If anchor spins in hole, force anchor up using screwdriver until clip binds into concrete.

